

Notes:

- Speakers
- "Area" Mics
- Bridge Mics
- Instrument Mics
- AKG C747
- AT 815b
- PCC 160
- Naiant UC
- SM 57

UofM / GUTHRIE THEATRE BFA
ACTOR TRAINING PROGRAM

AMERICAN CLOCK

**Dowling Studio
Groundplan**

Director: Joe Price
 Designer: Dustin Morache
 Dwg by: Dustin Morache
 As. Des.: Julie Zumsteg
 File: Audio Plot American Clock
 Date: 3/14/17 Rev Date:
 Scale: 1/4" = 1'-0"

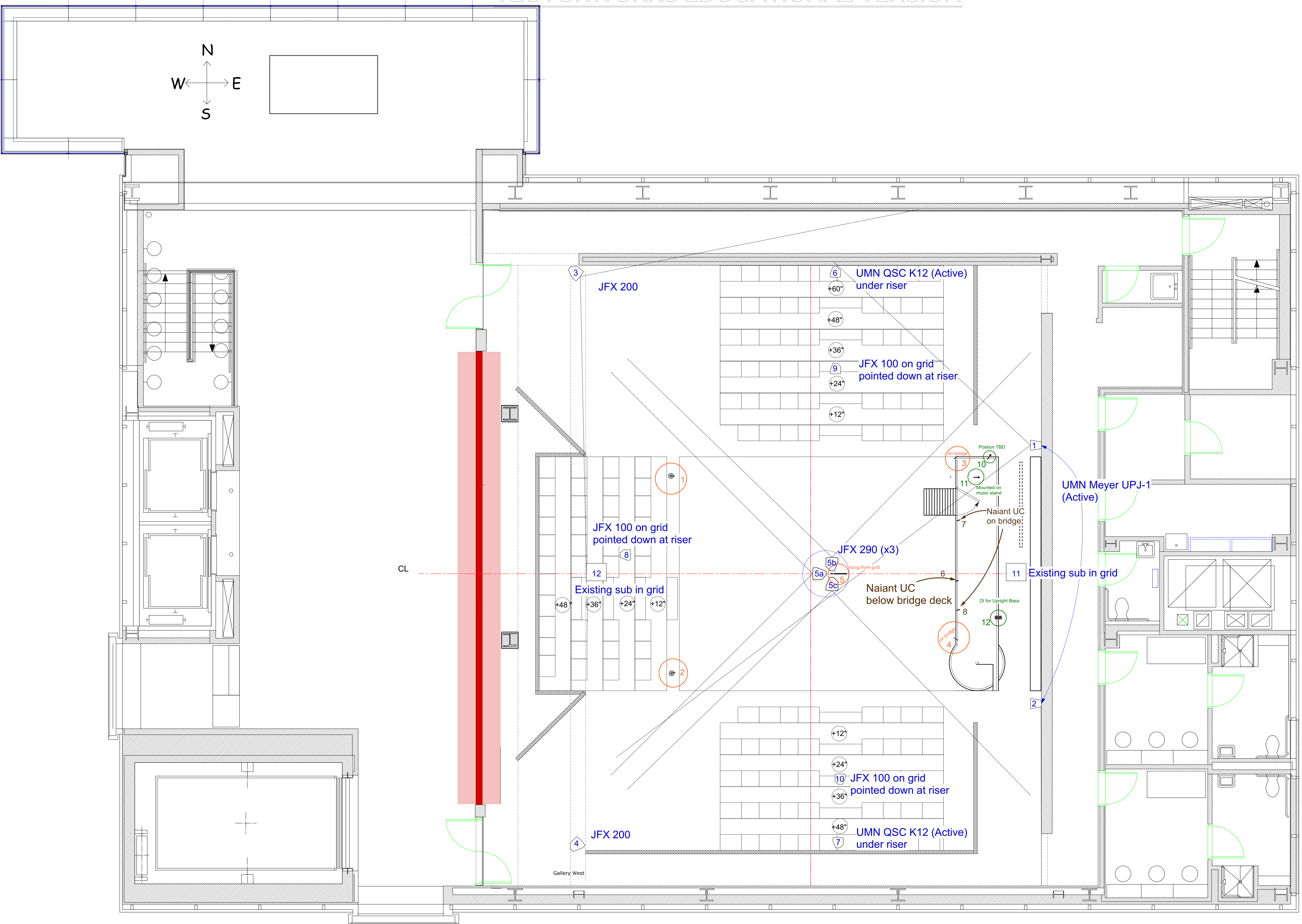

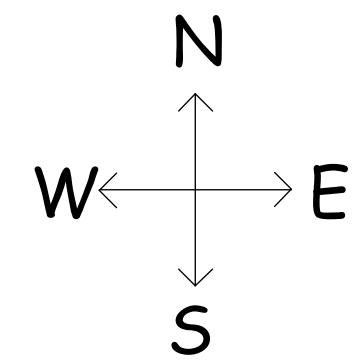

Notes:

- Speakers
- "Area" Mics
- Bridge Mics
- Instrument Mics

- AKG C747
- AT 815b
- PCC 160
- Naient UC
- SM 57

UofM / GUTHRIE THEATRE BFA
ACTOR TRAINING PROGRAM

AMERICAN CLOCK

**Dowling Studio
Groundplan**

Director: Joe Price
 Designer: Dustin Morache
 Dwg by: Dustin Morache
 As. Des: Julie Zumsteg
 File: Audio Plot American Clock - Piano
 Date: 3/14/17 Rev Date:
 Scale: 1/4" = 1'-0"

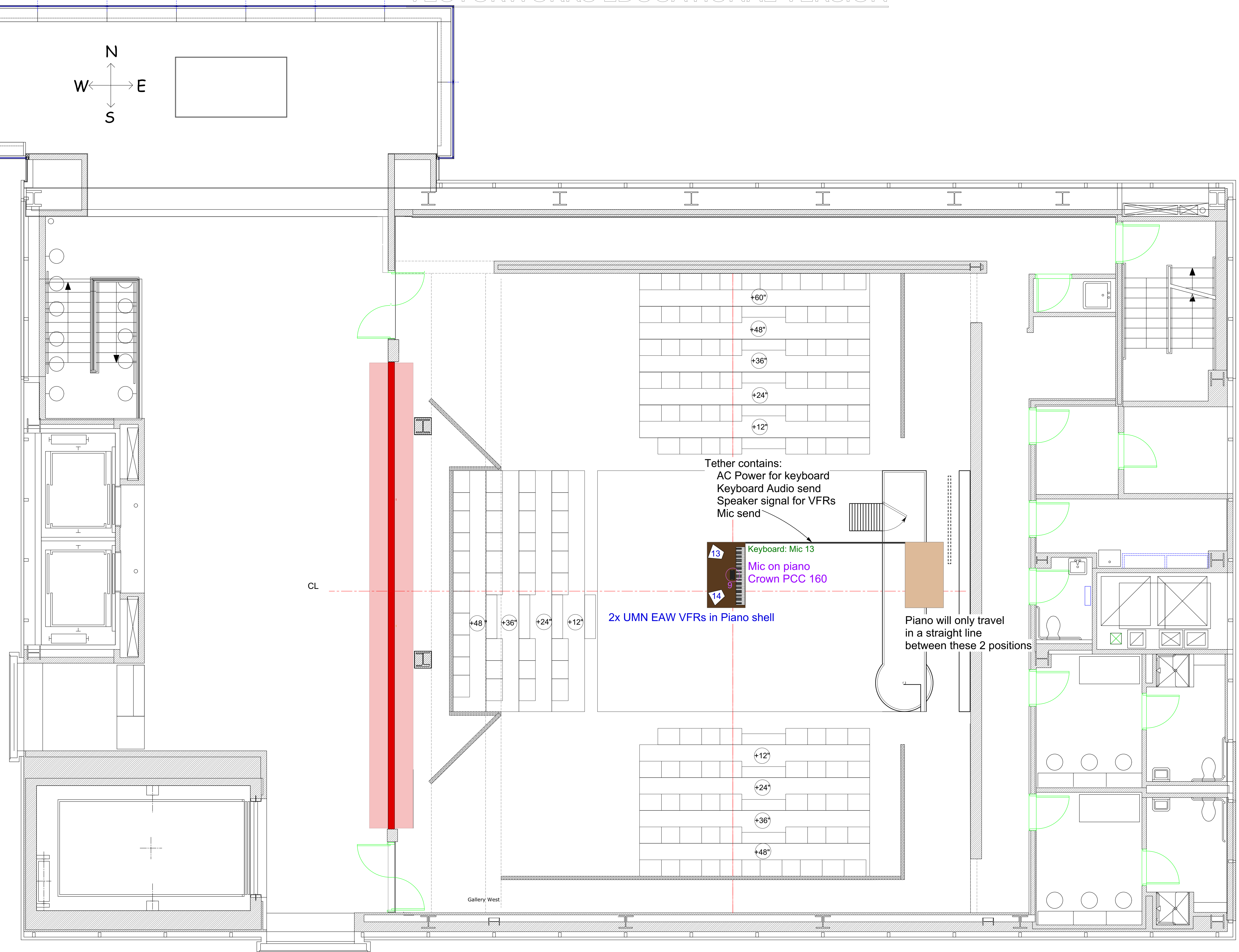

Tether contains:
 AC Power for keyboard
 Keyboard Audio send
 Speaker signal for VFRs
 Mic send

13 Keyboard: Mic 13
 Mic on piano
 Crown PCC 160
 14

2x UMN EAW VFRs in Piano shell

Piano will only travel
in a straight line
between these 2 positions

Gallery West

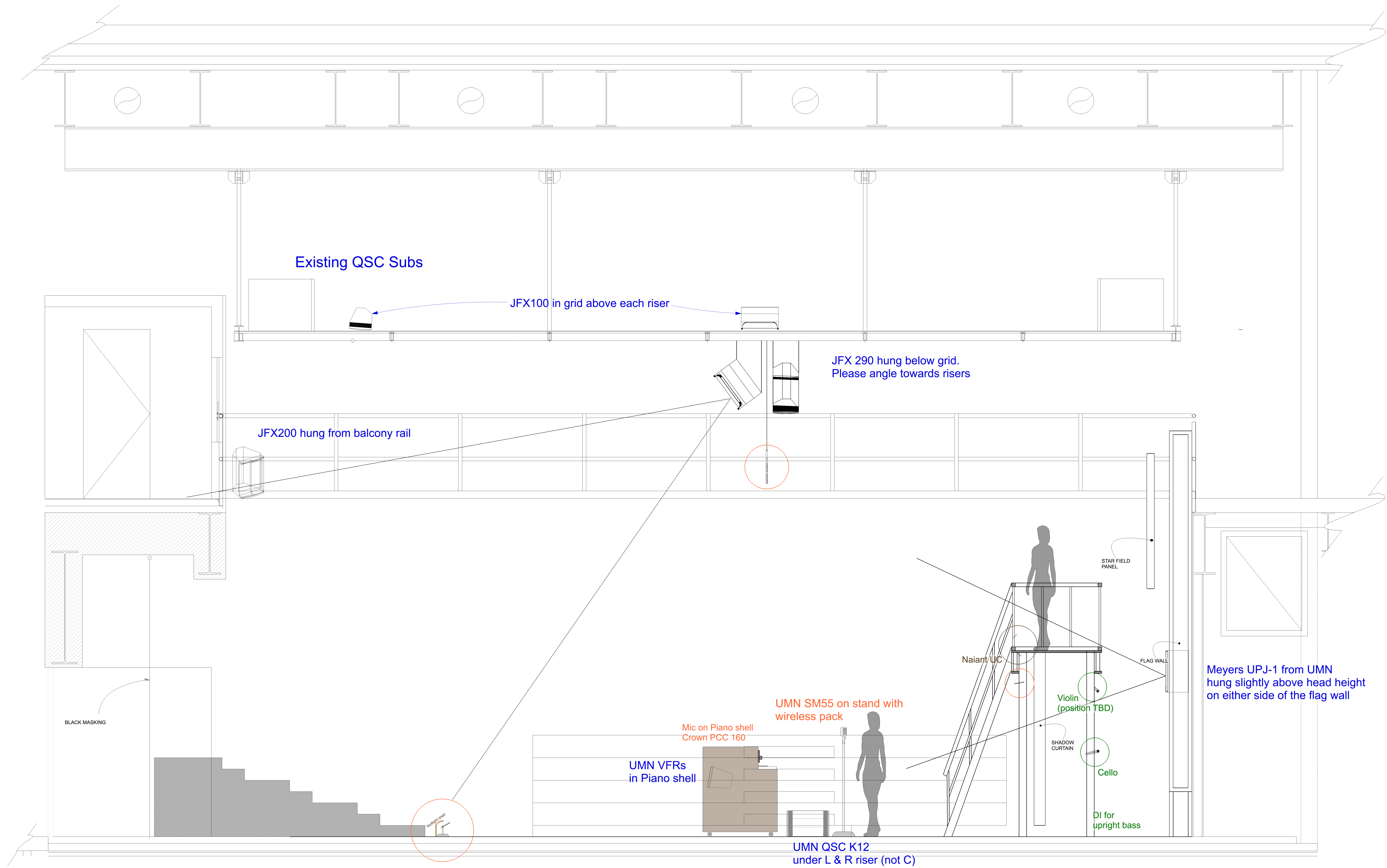





Notes:

Speakers

"Area" Mics

Bridge Mics

Instrument Mics

-  AKG C747
-  AT 815b
-  PCC 160
-  Naiant UC
-  SM 57

UofM / GUTHRIE THEATRE BEA
ACTOR TRAINING PROGRAM

AMERICAN CLOCK

Dowling Studio

SECTION

Director: Joe Price
Designer: Dustin Morache

Dwg by: Dustin Morache
As. Des.: Julie Zumsteg

File: AUDIO SECTION AMERICAN CLOCK

Date: Rev Date: 3/14/17

Scale: 1/2" = 1'-0"